

**BOMAG OSZILLATION  
BW 191 ADO-5, BW 206 ADO-5**

**PERFORMANCE DATA**



Machine type	Compaction output (m <sup>3</sup> /h) at recommended soil layer thicknesses		
	Gravel, sand	Mixed soil	Silt, clay
BW 191 ADO-5	260-500	180-360	140-220
BW 206 ADO-5	280-550	200-400	150-250

Machine type	Compaction output (t/h) at different asphalt layer thicknesses		
	2-4 cm	6-8 cm	10-14 cm
BW 191 ADO-5	70-120	120-230	190-300
BW 206 ADO-5	80-160	130-270	200-340

# Technical Data

Shipping dimensions in m3	without ROPS	with ROPS
<b>BW 191 ADO-5</b>	27,289	35,704
<b>BW 206 ADO-5</b>	28,980	37,917

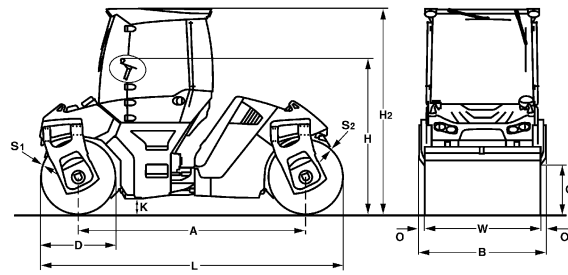

## Standard Equipment

- Front drum vibration: 2 amplitudes / 2 frequencies
- TanGO Rear drum Oscillation: 1 Amplitude/ 1 Frequency
- Highly wear resistant oscillation drum
- ECOMODE
- Autom. vibration operation
- Vibration and oscillation individually switchable
- Driver's seat, slewable - laterally slidable with steering wheel
- Emergency stop button
- On-board computer
  - engine speed
  - Speedometer
  - Fuel consumption
  - Engine temperature
- V-belt protection
- Pressure sprinkling system with 2 pumps
- Indicator and hazard lights
- Back-up alarm
- Battery disconnect switch
- Compartments for documents and tools

## Optional Equipment

- ROPS cabin with seat belts + heating, Ventilation + 4 Working head lights
- ROPS cabin with air conditioning
- Rotary beacon
- Crab-walk to both sides (170mm)
- 2 LED-lights for cabin roof (flatbeam)
- Edge cutter
- Special painting
- Environmentally compliant hydraulic oil
- Radio/Radio preparation
- ROPS/FOPS with safety belt
- Asphalt temperature display
- Lighting for drum edge front and rear
- Seat heating
- Frequency 70Hz
- Approval by the German TÜV
- BOMAG TELEMATIC POWER
- Outside mirrors
- ECONOMIZER
- BCM-Documentation system

## Dimensions in mm

	A	B	C	D	H	H2	K	L	O	S1	S2	W
<b>BW 191 ADO-5</b>	3900	2178	760	1400	2364	3093	250	5300	89	19	13	2000
<b>BW 206 ADO-5</b>	3900	2313	760	1400	2364	3093	250	5300	89	19	13	2135

## Technical Data

### Weights

	BOMAG BW 191 ADO-5	BOMAG BW 206 ADO-5
Operating weight CECE w. cab. ....	kg 13.100	13.650
Axle load, front CECE .....	kg 6.650	7.200
Axle load, rear CECE .....	kg 6.450	6.450
Static linear load, front CECE .....	kg/cm 33,3	33,7
Static linear load, rear CECE .....	kg/cm 32,3	32,4
Grossweight .....	kg 14.300	15.700

### Dimensions

Track radius, inner .....	mm 5.190	5.117
---------------------------	----------	-------

### Driving Characteristics

Max. travel speed .....	km/h 0- 12,0	0- 12,0
-------------------------	--------------	---------

### Drive

	BOMAG BW 191 ADO-5	BOMAG BW 206 ADO-5
Engine manufacturer .....	Deutz	Deutz
Type .....	TCD 4.1 L04	TCD 4.1 L04
Emission stage .....	4/4	4/4
Cooling .....	water	water
Number of cylinders .....	4	4
Performance ISO 14396 .....	kW 105,0	105,0
Speed .....	min-1 2.300	2.300
Electric equipment .....	V 12	12

### Brakes

Service brake .....	hydrost.	hydrost.
Parking brake .....	multi disc	multi disc

### Steering

Steering system .....	oscil.artic.	oscil.artic.
-----------------------	--------------	--------------

### Exciter system

Vibrating drum .....	front + rear	front + rear
Autom. vibr. shut off .....	standard	standard
Frequency .....	Hz 40/55	40/55
Amplitude .....	mm 0,94/0,44	0,94/0,44
Centrifugal force .....	kN 129/113	129/113
Centrifugal force .....	t 13,1/11,5	13,1/11,5
Oscillating drum .....		
O. Frequency .....	Hz 40	40
O. Amplitude .....	mm 1,43	1,38

### Capacities

Fuel .....	l 165,0	165,0
Water .....	l 970,0	970,0

Technical modifications reserved. Machines may be shown with options.

